

TTI Model Number: 018 156 023DG9

Starting Serial Number:

M18™ FUEL 100MM BRAKING GRINDER

VERSION A - C2018

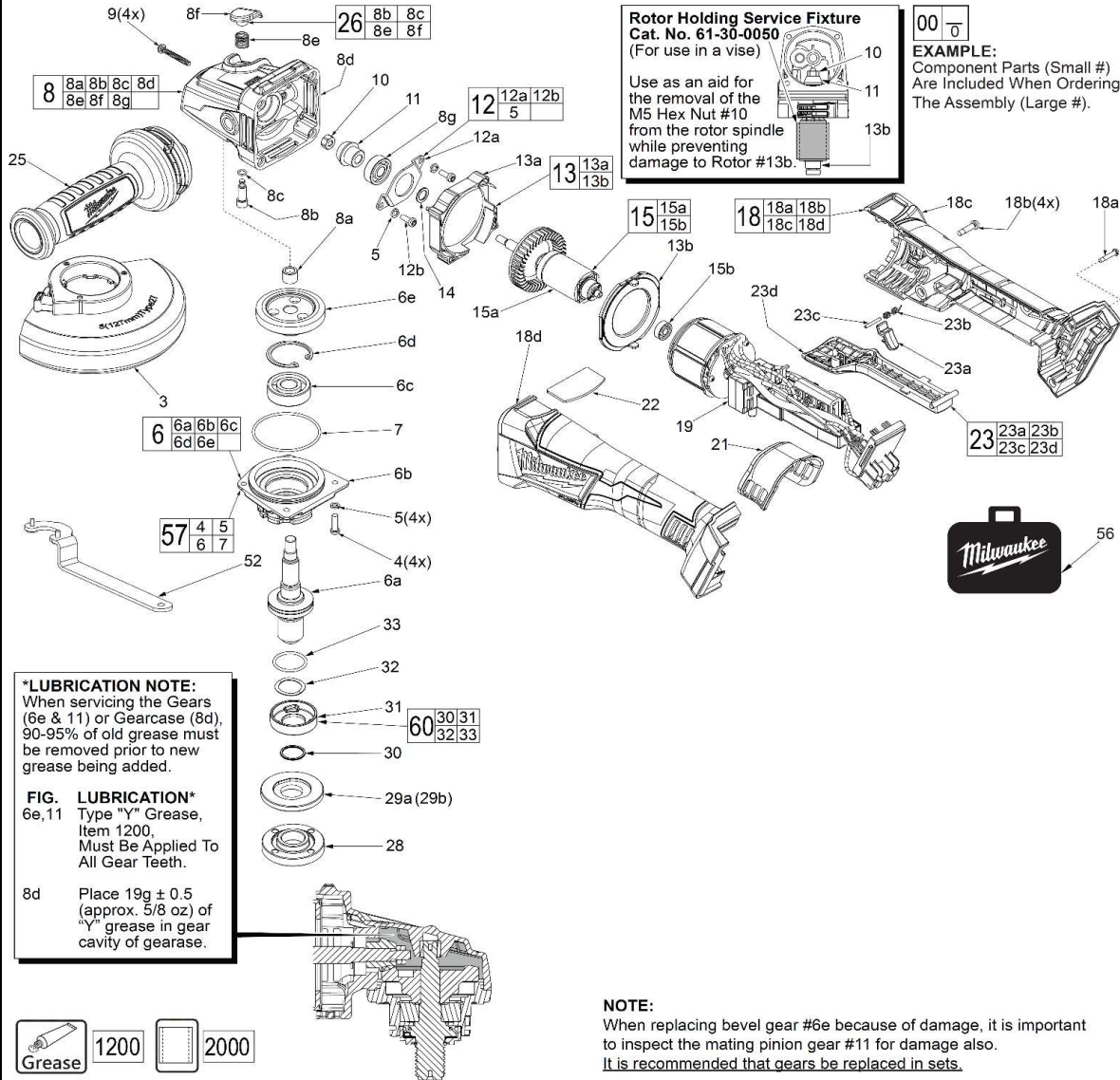



M18 CAG100XPDB

SERVICE PARTS LIST

Bulletin Date:
Mar-18

TTI Model Number: 018 156 023DG9

Starting Serial Number:

M18™ FUEL 100MM BRAKING GRINDER

VERSION A - C2018

ITEM	PART NUMBER	PART DISCRIPTION	QTY (PCS)
3	201647011	4" TYPE 27 GUARD ASSEMBLY	1
4	660414013	M4x14MM SCREW	4
5	680866003	SPRING WASHER	6
6	202610004	SPINDLE HUB ASSEMBLY	1
6a	-	OUTPUT SHAFT	1
6b	-	SPINDLE HUB	1
6c	-	BALL BEARING	1
6d	-	RETAINING RING	1
6e	-	BEVEL GEAR	1
7	562584001	O-RING	1
8	202611003	GEAR CASE ASSEMBLY	1
8a	-	NEEDLE BEARING	1
8b	-	SPINDLE LOCK PIN	1
8c	-	O-RING	1
8d	-	GEAR CASE	1
8e	-	SPINDLE LOCK SPRING	1
8f	-	SPINDLE LOCK BUTTON	1
8g	-	BALL BEARING	1
9	660024035	M4x28MM SCREW	4
10	671686001	M5 HEX NUT	1
11	613496001	PINION GEAR	1
12	202615001	BEARING RETAINING PLATE ASSEMBLY	1
12a	672569001	BEARING RATAINER	1
12b	660400005	M4x10MM SCREW	2
13	202614001	BAFFLE ASSEMBLY	1
13a	-	FAN BAFFLE	1
13b	-	FAN BAFFLE FOOT	1
14	632876001	WASHER	1
15	202616001	ROTOR ASSEMBLY	1
15a	-	ROTOR	1
15b	681366001	BALL BEARING	1
18	203676001	HOUSING KIT	1



M18 CAG100XPDB

SERVICE PARTS LIST

Bulletin Date:
Mar-18

TTI Model Number: 018 156 023DG9

Starting Serial Number:

M18™ FUEL 100MM BRAKING GRINDER

VERSION A - C2018

ITEM	PART NUMBER	PART DISCRIPTION	QTY (PCS)
18b	660024030	M4x16MM SCREW	4
18a	660274003	4-20x5/8" SCREW	1
18c	-	HANDLE COVER - RIGHT	1
18d	-	HANDLE SUPPORT - LEFT	1
19	203683001	ELECTRONICS ASSEMBLY	1
21	305952001	DUST COVER	1
22	351784001	LOGO PLATE	1
23	203581001	PADDLE TRIGGER ASSEMBLY	1
23a	-	LOCK-OFF LEVEL	1
23b	-	LOCK-OFF SPRING	1
23c	-	LOCK-OFF PIN	1
23d	-	PADDLE TRIGGER	1
25	304057001	SIDE HANDLE ASSEMBLY	1
26	202617001	SPINDLE LOCK KIT	1
27	941048386	SERVICE NAMEPLATE (NOT SHOWN)	1
28	672568014	FLANGE NUT	1
29a	673448001	FLANGE DISC,100x16MM	1
29b	673448003	FLANGE DISC,100x15MM - ONLY FOR KOREA	1
30	672991002	FLANGE WITH RAMPS	1
31	633400002	RATAINING RING	1
32	633475002	WAVE WASHER	1
33	562518001	O-RING	1
52	632145003	SPANNER WRENCH	1
56	307640029	BLOW MOLDED CARRYING CASE	1
57	202610004	SPINDLE HUB ASSEMBLY	1
60	201767003	FLANGE WITH RAMPS ASSEMBLY	1
1200	-	TYPE Y GREASE	1
2000	61-30-0050	ROTOR HOLDING SERVICE FIXTURE	1

**WIRE ROUTING AND TRAPPING
for the ELECTRONICS KIT in the
HANDLE SUPPORT (Left Handle Halve)**

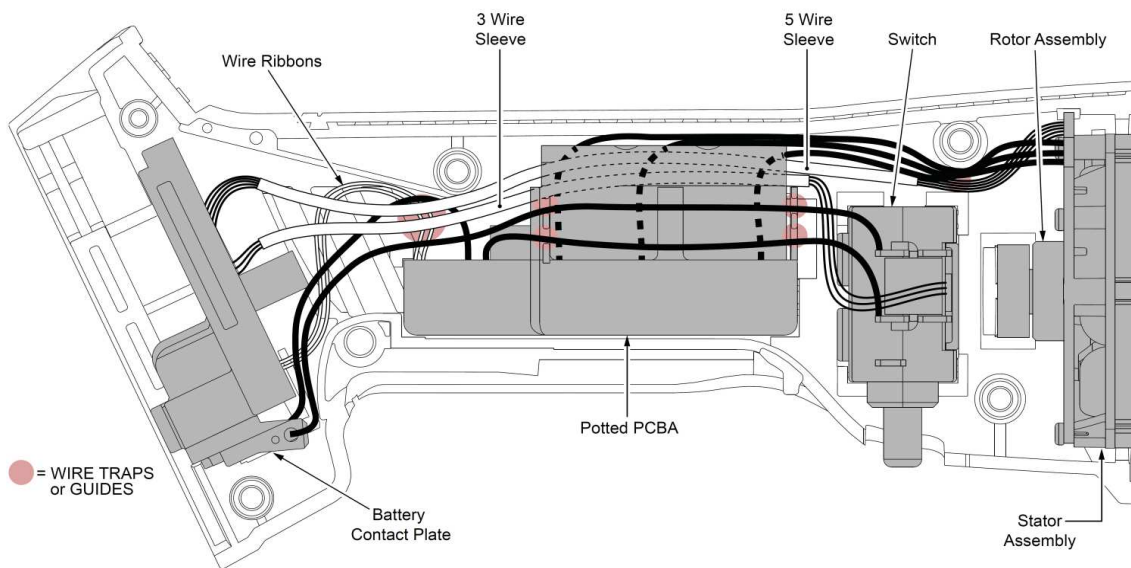

AS AN AID TO REASSEMBLY, TAKE NOTICE OF WIRE ROUTING AND POSITION IN WIRE GUIDES AND TRAPS WHILE DISMANTLING TOOL.

BE SURE THAT ALL COMPONENTS OF THE ELECTRONICS KIT ARE SEATED FIRMLY AND SQUARELY IN THE HANDLE RECESSES.

AVOID PINCHED WIRES, BE SURE THAT ALL WIRES AND SLEEVES ARE PRESSED COMPLETELY DOWN IN WIRE GUIDES AND TRAPS.

PRIOR TO INSTALLING THE HANDLE COVER ONTO THE HANDLE SUPPORT, BE SURE THAT THERE ARE NO INTERFERENCES.

SCREW TORQUE SPECIFICATIONS

FIG.	PART NO.	WHERE USED	SEAT TORQUE	
			(KG/CM)	(Nm)
4	660414013	Spindle Hub Assembly	20-26	1.92-2.49
9	660024035	Gear Case	13-19	1.24-1.81
10	671686001	Pinion Gear	100	9.72
18a	660274003	Housing Kit	13-19	1.24-1.81
18b	660024030	Housing Kit	6-12	0.57-1.13